

HSK 63/E

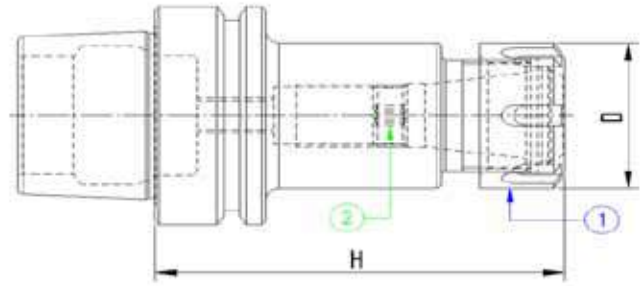



**STANDARD**

Codice	HSK	Descrizione	ER	D	H	G2.5 20000
66EPP110	63/E	HSK63/E DIN69893 P/P H75 ER16	16	32	75	●
66EPP116	63/E	HSK63/E DIN69893 P/P H75 ER25	25	42	75	●
66EPP120	63/E	HSK63/E DIN69893 P/P H75 ER32	32	50	75	●
66EPP126	63/E	HSK63/E DIN69893 P/P H75 ER40	40	63	75	●

**L=100**

Codice	HSK	Descrizione	ER	D	H	G2.5 20000
66EPP210	63/E	HSK63/E DIN69893 P/P H100 ER16	16	32	100	●
66EPP216	63/E	HSK63/E DIN69893 P/P H100 ER25	25	42	100	●
66EPP220	63/E	HSK63/E DIN69893 P/P H100 ER32	32	50	100	●
66EPP226	63/E	HSK63/E DIN69893 P/P H100 ER40	40	63	100	●

**COMPONENTI - SPARE PARTS - PIECES DETACHEES - ERSATZTEILE**

ER	Ghiera Interna	Q.tà	Ghiera	Q.tà
				
16	101001601	1	916GHREQ	1
25	101815801	1	925GHREQ	1
32	102215901	1	932GHREQ	1
40	102215901	1	940GHREQ	1

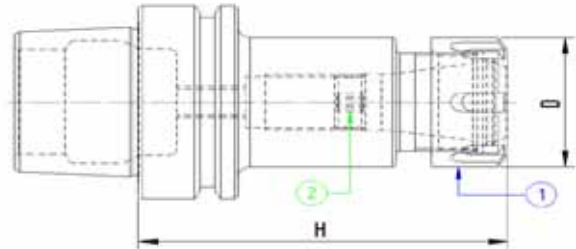

### L=120

Codice	HSK	Descrizione	ER	D	H	G2.5 20000
66EPP310	63/E	HSK63/E DIN69893 P/P H120 ER16	16	32	120	●
66EPP316	63/E	HSK63/E DIN69893 P/P H120 ER25	25	42	120	●
66EPP320	63/E	HSK63/E DIN69893 P/P H120 ER32	32	50	120	●
66EPP326	63/E	HSK63/E DIN69893 P/P H120 ER40	40	63	120	●

### L=160

Codice	HSK	Descrizione	ER	D	H	G2.5 20000
66EPP410	63/E	HSK63/E DIN69893 P/P H160 ER16	16	32	160	●
66EPP416	63/E	HSK63/E DIN69893 P/P H160 ER25	25	42	160	●
66EPP420	63/E	HSK63/E DIN69893 P/P H160 ER32	32	50	160	●
66EPP426	63/E	HSK63/E DIN69893 P/P H160 ER40	40	63	160	●

### COMPONENTI - SPARE PARTS - PIECES DETACHEES - ERSATZTEILE

ER	Ghiera Interna	Q.tà	Ghiera	Q.tà
16	101001601	1	916GHREQ	1
25	101815801	1	925GHREQ	1
32	102215901	1	932GHREQ	1
40	102215901	1	940GHREQ	1

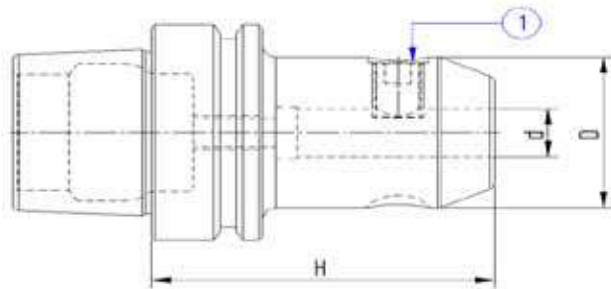

Codice	HSK	Descrizione	d	D	H	G2.5 20000
66EWLD06	63/E	HSK63/E DIN69893 WELDON H65 D06	6	25	65	●
66EWLD08	63/E	HSK63/E DIN69893 WELDON H65 D08	8	28	65	●
66EWLD10	63/E	HSK63/E DIN69893 WELDON H70 D10	10	35	70	●
66EWLD12	63/E	HSK63/E DIN69893 WELDON H80 D12	12	42	80	●
66EWLD14	63/E	HSK63/E DIN69893 WELDON H80 D14	14	44	80	●
66EWLD16	63/E	HSK63/E DIN69893 WELDON H80 D16	16	48	80	●
66EWLD18	63/E	HSK63/E DIN69893 WELDON H80 D18	18	50	80	●
66EWLD20	63/E	HSK63/E DIN69893 WELDON H80 D20	20	52	80	●
66EWLD25	63/E	HSK63/E DIN69893 WELDON H105 D25	25	65	105	●
66EWLD32	63/E	HSK63/E DIN69893 WELDON H110 D32	32	72	110	●

**COMPONENTI - SPARE PARTS - PIECES DETACHEES - ERSATZTEILE**

Ø WLD	Grano	Q.tà
-------	-------	------



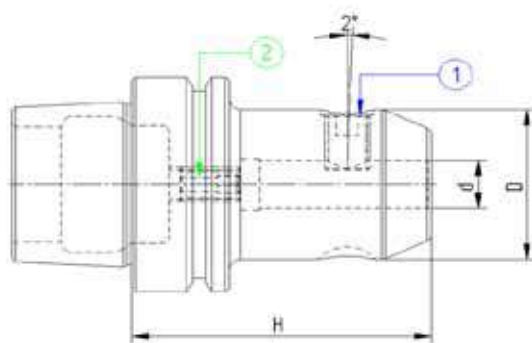

6	100601002	1
8	100801002	1
10	101001202	1
12 - 14	101201602	1
16 - 18	101401602	1
20	101601602	1
25	101802002	2
32	102002002	2



Codice	HSK	Descrizione	d	D	H	G2.5 20000
66EWHN06	63/E	HSK63/E DIN69893 W/NOTCH H65 D06	6	25	65	●
66EWHN08	63/E	HSK63/E DIN69893 W/NOTCH H65 D08	8	28	65	●
66EWHN10	63/E	HSK63/E DIN69893 W/NOTCH H65 D10	10	35	65	●
66EWHN12	63/E	HSK63/E DIN69893 W/NOTCH H80 D12	12	42	80	●
66EWHN14	63/E	HSK63/E DIN69893 W/NOTCH H80 D14	14	44	80	●
66EWHN16	63/E	HSK63/E DIN69893 W/NOTCH H80 D16	16	44	80	●
66EWHN18	63/E	HSK63/E DIN69893 W/NOTCH H80 D18	18	50	80	●
66EWHN20	63/E	HSK63/E DIN69893 W/NOTCH H80 D20	20	52	80	●
66EWHN25	63/E	HSK63/E DIN69893 W/NOTCH H100 D25	25	65	100	●
66EWHN32	63/E	HSK63/E DIN69893 W/NOTCH H100 D32	32	72	100	●

**COMPONENTI - SPARE PARTS - PIECES DETACHEES - ERSATZTEILE**

Ø WHN	Grano	Q.tà	Grano Interno	Q.tà
				
	<b>1</b>		<b>2</b>	
6	100601002	1	100501601	1
8	100801002	1	100601601	1
10	101001202	1	-	-
12 - 14	101201602	1	101001601	1
16 - 18	101401602	1	101001601	1
20	101601602	1	101001601	1
25	101802002	2	101001601	1
32	102002002	2	101001601	1

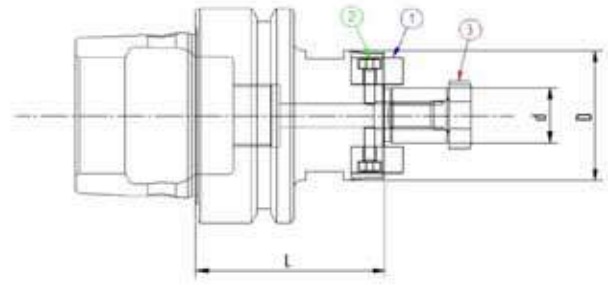

**STANDARD**

Codice	HSK	Descrizione	d	D	L	G2.5 20000
66EPF116	63/E	HSK63/E DIN69893 P/F FISSO H50 D16	16	38	50	●
66EPF122	63/E	HSK63/E DIN69893 P/F FISSO H50 D22	22	48	50	●
66EPF127	63/E	HSK63/E DIN69893 P/F FISSO H60 D27	27	58	60	●
66EPF132	63/E	HSK63/E DIN69893 P/F FISSO H60 D32	32	66	60	●
66EPF140	63/E	HSK63/E DIN69893 P/F FISSO H65 D40	40	80	65	●

**L=100**

Codice	HSK	Descrizione	d	D	L	G2.5 20000
66EPF216	63/E	HSK63/E DIN69893 P/F FISSO H100 D16	16	38	100	●
66EPF222	63/E	HSK63/E DIN69893 P/F FISSO H100 D22	22	48	100	●
66EPF227	63/E	HSK63/E DIN69893 P/F FISSO H100 D27	27	58	100	●
66EPF232	63/E	HSK63/E DIN69893 P/F FISSO H100 D32	32	66	100	●
66EPF240	63/E	HSK63/E DIN69893 P/F FISSO H100 D40	40	80	100	●

**COMPONENTI - SPARE PARTS - PIECES DETACHEES - ERSATZTEILE**

d / D	Tassello	Q.tà	Vite Tassello	Q.tà	Vite Croce	Q.tà
						
	<b>1</b>		<b>2</b>		<b>3</b>	
16 / 38	916TSL01	2	110301001	2	916VTC02	1
22 / 48	922TSL01	2	110301201	2	922VTC02	1
27 / 58	927TSL01	2	110401601	2	927VTC02	1
32 / 66	932TSL01	2	110601601	2	932VTC02	1
40 / 80	940TSL01	2	110601601	2	940VTC02	1

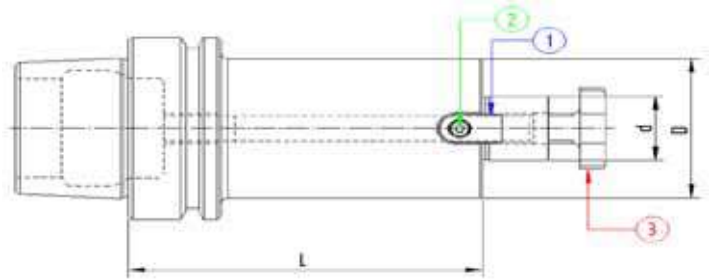

**L=130**

Codice	HSK	Descrizione	d	D	L	G2.5 20000
66EPF316	63/E	HSK63/E DIN69893 P/F FISSO H130 D16	16	38	130	●
66EPF322	63/E	HSK63/E DIN69893 P/F FISSO H130 D22	22	48	130	●
66EPF327	63/E	HSK63/E DIN69893 P/F FISSO H130 D27	27	58	130	●
66EPF332	63/E	HSK63/E DIN69893 P/F FISSO H130 D32	32	66	130	●
66EPF340	63/E	HSK63/E DIN69893 P/F FISSO H130 D40	40	80	130	●

**L=160**

Codice	HSK	Descrizione	d	D	L	G2.5 20000
66EPF416	63/E	HSK63/E DIN69893 P/F FISSO H160 D16	16	38	160	●
66EPF422	63/E	HSK63/E DIN69893 P/F FISSO H160 D22	22	48	160	●
66EPF427	63/E	HSK63/E DIN69893 P/F FISSO H160 D27	27	58	160	●
66EPF432	63/E	HSK63/E DIN69893 P/F FISSO H160 D32	32	66	160	●
66EPF440	63/E	HSK63/E DIN69893 P/F FISSO H160 D40	40	80	160	●

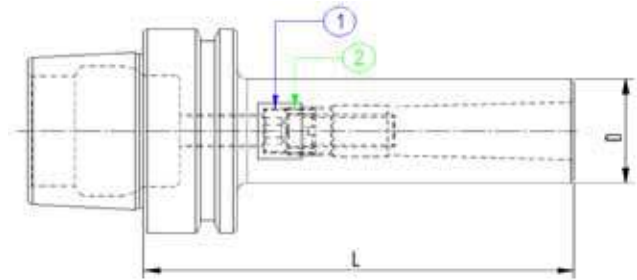

**COMPONENTI - SPARE PARTS - PIECES DETACHEES - ERSATZTEILE**

d / D	Tassello	Q.tà	Vite Tassello	Q.tà	Vite Croce	Q.tà
						
	<b>1</b>		<b>2</b>		<b>3</b>	
16 / 38	916TSL01	2	110301001	2	916VTC02	1
22 / 48	922TSL01	2	110301201	2	922VTC02	1
27 / 58	927TSL01	2	110401601	2	927VTC02	1
32 / 66	932TSL01	2	110601601	2	932VTC02	1
40 / 80	940TSL01	2	110601601	2	940VTC02	1



<b>Codice</b>	<b>HSK</b>	<b>Descrizione</b>	<b>MORSE</b>	<b>D</b>	<b>L</b>
66EMF101	63/E	HSK63/E DIN69893 H100 CM1FRESE	1	25	100
66EMF102	63/E	HSK63/E DIN69893 H125 CM2FRESE	2	32	125
66EMF103	63/E	HSK63/E DIN69893 H145 CM3FRESE	3	40	145
66EMF104	63/E	HSK63/E DIN69893 H165 CM4FRESE	4	48	165

**COMPONENTI - SPARE PARTS - PIECES DETACHEES - ERSATZTEILE**

<b>HSK</b>	<b>Vite</b>	<b>Q.tà</b>	<b>Boccola</b>	<b>Q.tà</b>
				
	<b>1</b>		<b>2</b>	
CM1	110603501	1	121206502	1
CM2	111003014	1	121500802	1
CM3	111204003	1	122000903	1
CM4	111604514	1	122501204	1





**MANDRINI ATTACCO CONO MORSE PER PUNTE**  
**MORSE TAPER ADAPTORS FOR DRILL**  
**DOUILLES POUR CONE MORSE A TENON**  
**ZWISCHENHULSEN FUER MORSEKEGEL MIT AUSTREIBLAPPEN**

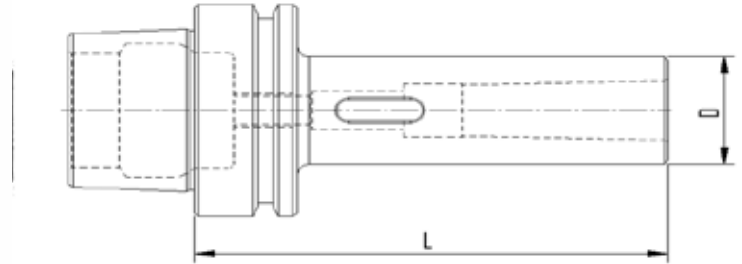

**DIN 69893**  
**DIN 228-2**

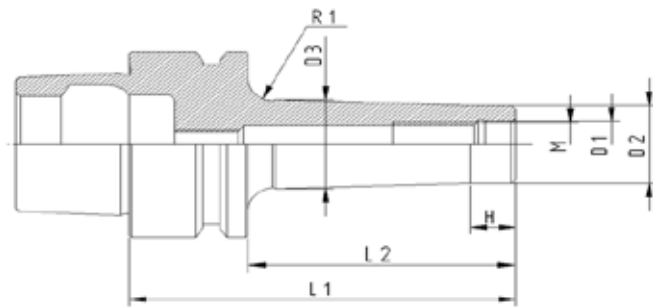

<b>Codice</b>	<b>HSK</b>	<b>Descrizione</b>	<b>MORSE</b>	<b>D</b>	<b>L</b>
66EMP101	63/E	HSK63/E DIN69893 H100 CM1PUNTE	1	25	100
66EMP102	63/E	HSK63/E DIN69893 H120 CM2PUNTE	2	32	120
66EMP103	63/E	HSK63/E DIN69893 H140 CM3PUNTE	3	40	140
66EMP104	63/E	HSK63/E DIN69893 H165 CM4PUNTE	4	48	165



**L = 59**

Codice	Descrizione	D1	D2	D3	H	L1	L2	M	G2.5 20000
66EAF106	HSK63/E DIN69893 P/F AT.FIL.M6x59	6.5	9.7	9.7	-	59	33	M6	●
66EAF108	HSK63/E DIN69893 P/F AT.FIL.M8x59	8.5	13	15	10	59	33	M8	●
66EAF110	HSK63/E DIN69893 P/F AT.FIL.M10x59	10.5	18	20	10	59	33	M10	●
66EAF112	HSK63/E DIN69893 P/F AT.FIL.M12x59	12.5	21	24	10	59	33	M12	●
66EAF116	HSK63/E DIN69893 P/F AT.FIL.M16x59	17.0	29	34	10	59	33	M16	●

**L = 84**

Codice	Descrizione	D1	D2	D3	H	L1	L2	M	G2.5 20000
66EAF206	HSK63/E DIN69893 P/F AT.FIL.M6x84	6.5	9.7	20	10	84	58	M6	●
66EAF208	HSK63/E DIN69893 P/F AT.FIL.M8x84	8.5	13	23	10	84	58	M8	●
66EAF210	HSK63/E DIN69893 P/F AT.FIL.M10x84	10.5	18	25	10	84	58	M10	●
66EAF212	HSK63/E DIN69893 P/F AT.FIL.M12x84	12.5	21	24	10	84	58	M12	●
66EAF216	HSK63/E DIN69893 P/F AT.FIL.M16x84	17.0	29	34	10	84	58	M16	●

**L = 109**

Codice	Descrizione	D1	D2	D3	H	L1	L2	M	G2.5 20000
66EAF306	HSK63/E DIN69893 P/F AT.FIL.M6x109	6.5	9.7	23	10	109	83	M6	●
66EAF308	HSK63/E DIN69893 P/F AT.FIL.M8x109	8.5	13	23	10	109	83	M8	●
66EAF310	HSK63/E DIN69893 P/F AT.FIL.M10x109	10.5	18	28	10	109	83	M10	●
66EAF312	HSK63/E DIN69893 P/F AT.FIL.M12x109	12.5	21	31	10	109	83	M12	●
66EAF316	HSK63/E DIN69893 P/F AT.FIL.M16x109	17.0	29	34	10	109	83	M16	●

**L = 134**

Codice	Descrizione	D1	D2	D3	H	L1	L2	M	G2.5 20000
66EAF408	HSK63/E DIN69893 P/F AT.FIL.M8x134	8.5	13	25	10	134	108	M8	●
66EAF410	HSK63/E DIN69893 P/F AT.FIL.M10x134	10.5	18	30	10	134	108	M10	●
66EAF412	HSK63/E DIN69893 P/F AT.FIL.M12x134	12.5	21	31	10	134	108	M12	●
66EAF416	HSK63/E DIN69893 P/F AT.FIL.M16x134	17.0	29	39	10	134	108	M16	●

**L = 159**

Codice	Descrizione	D1	D2	D3	H	L1	L2	M	G2.5 20000
66EAF512	HSK63/E DIN69893 P/F AT.FIL.M12x159	12.5	21	31	10	159	133	M12	●
66EAF516	HSK63/E DIN69893 P/F AT.FIL.M16x159	17.0	29	39	10	159	133	M16	●

**MANDRINI SEMILAVORATI A STELO TENERO**  
 BLANK TOOLHOLDER WITH SOFT SHANK  
 BARRES D'ALEPAGE SEMI-FINIES  
 ROHLINGE MIT WEICHEM SCHAFT



**DIN 69893**



<b>Codice</b>	<b>HSK</b>	<b>Descrizione</b>	<b>D</b>	<b>L</b>
66EST263	63/E	HSK63/E DIN69893 ST.TENERO D.63x200	63	200
66EST380	63/E	HSK63/E DIN69893 ST.TENERO D.80x250	80	250