

The background image shows three metal tool holders of varying lengths and diameters, arranged diagonally on a light gray grid. A red curved line highlights the conical part of the holders. To the right, a portion of a larger metal component is visible.

Базовые держатели

BT (MAS403)-ER (Коническая цапга)

BALANCED
G6.3
12 000 об/мин

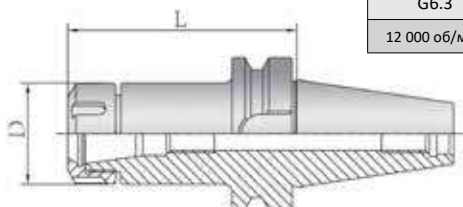

| Обозначение | D | L1 | Диапазон |
|----------------|----|-----|----------|
| BT30-ER11-70 | 19 | 70 | 0.5-7 |
| BT30-ER11-100 | 19 | 100 | 0.5-7 |
| BT30-ER16-70 | 28 | 70 | 0.5-10 |
| BT30-ER16-100 | 28 | 100 | 0.5-10 |
| BT30-ER20-70 | 34 | 70 | 0.5-13 |
| BT30-ER20-100 | 34 | 100 | 0.5-13 |
| BT30-ER25-70 | 42 | 70 | 0.5-16 |
| BT30-ER25-100 | 42 | 100 | 0.5-16 |
| BT30-ER32-70 | 50 | 70 | 1-20 |
| BT30-ER32-100 | 50 | 100 | 1-20 |
| BT30-ER40-80 | 63 | 80 | 2-26 |
| BT40-ER16-70 | 28 | 70 | 0.5-10 |
| BT40-ER16-100 | 28 | 100 | 0.5-10 |
| BT40-ER16-150 | 28 | 150 | 0.5-10 |
| BT40-ER20-70 | 34 | 70 | 0.5-13 |
| BT40-ER20-100 | 34 | 100 | 0.5-13 |
| BT40-ER120-150 | 34 | 150 | 0.5-13 |
| BT40-ER25-70 | 42 | 70 | 0.5-16 |
| BT40-ER25-100 | 42 | 100 | 0.5-16 |
| BT40-ER25-150 | 42 | 150 | 0.5-16 |
| BT40-ER32-70 | 50 | 70 | 1-20 |
| BT40-ER32-100 | 50 | 100 | 1-20 |
| BT40-ER32-150 | 50 | 150 | 1-20 |
| BT40-ER40-80 | 63 | 80 | 2-26 |

Смотри
следующую страницу

BT (MAS403)-ER (Коническая цапга)

BALANCED
G6.3

12 000 об/мин

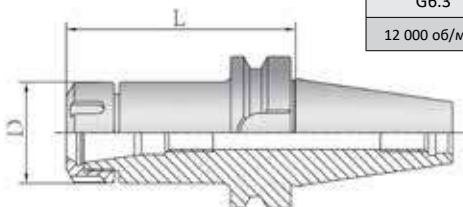

| Обозначение | D | L1 | Диапазон |
|---------------|----|-----|----------|
| BT40-ER40-100 | 63 | 100 | 2-26 |
| BT40-ER40-120 | 63 | 120 | 2-26 |
| BT40-ER40-150 | 63 | 150 | 2-26 |
| BT50-ER16-70 | 28 | 70 | 0.5-10 |
| BT50-ER16-100 | 28 | 100 | 0.5-10 |
| BT50-ER16-150 | 28 | 150 | 0.5-10 |
| BT50-ER20-70 | 34 | 70 | 0.5-13 |
| BT50-ER20-100 | 34 | 100 | 0.5-13 |
| BT50-ER20-150 | 34 | 150 | 0.5-13 |
| BT50-ER20-200 | 34 | 200 | 0.5-13 |
| BT50-ER25-70 | 42 | 70 | 0.5-16 |
| BT50-ER25-100 | 42 | 100 | 0.5-16 |
| BT50-ER25-150 | 42 | 150 | 0.5-16 |
| BT50-ER25-200 | 42 | 200 | 0.5-16 |
| BT50-ER32-80 | 50 | 80 | 1-20 |
| BT50-ER32-100 | 50 | 100 | 1-20 |
| BT50-ER32-150 | 50 | 150 | 1-20 |
| BT50-ER32-200 | 50 | 200 | 1-20 |
| BT50-ER40-80 | 63 | 80 | 2-26 |
| BT50-ER40-100 | 63 | 100 | 2-26 |
| BT50-ER40-120 | 63 | 120 | 2-26 |
| BT50-ER40-150 | 63 | 150 | 2-26 |

с.382

с.385

с.392

с.391



BT (MAS403)-FMB (Торцевое крепление)

BALANCED
G6.3

12 000 об/мин

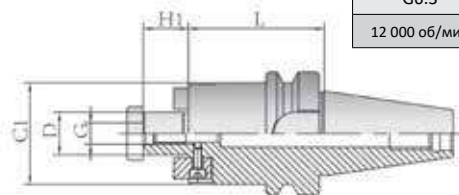

| Обозначение | D | L | C1 | H1 | G |
|----------------|----|-----|----|----|-----|
| BT30-FMB22-45 | 22 | 45 | 48 | 19 | M10 |
| BT30-FMB22-60 | 22 | 60 | 48 | 19 | M10 |
| BT30-FMB27-45 | 27 | 45 | 60 | 21 | M12 |
| BT30-FMB27-60 | 27 | 60 | 60 | 21 | M12 |
| BT40-FMB22-45 | 22 | 45 | 48 | 19 | M10 |
| BT40-FMB22-60 | 22 | 60 | 48 | 19 | M10 |
| BT40-FMB22-90 | 22 | 90 | 48 | 19 | M10 |
| BT40-FMB22-150 | 22 | 150 | 48 | 19 | M10 |
| BT40-FMB27-45 | 27 | 45 | 60 | 21 | M12 |
| BT40-FMB27-60 | 27 | 60 | 60 | 21 | M12 |
| BT40-FMB27-90 | 27 | 90 | 60 | 21 | M12 |
| BT40-FMB32-60 | 32 | 60 | 78 | 24 | M16 |
| BT40-FMB40-60 | 40 | 60 | 89 | 27 | M20 |
| BT50-FMB22-45 | 22 | 45 | 48 | 19 | M10 |
| BT50-FMB22-90 | 22 | 90 | 48 | 19 | M10 |
| BT50-FMB22-150 | 22 | 150 | 48 | 19 | M10 |
| BT50-FMB27-90 | 27 | 90 | 60 | 21 | M12 |
| BT50-FMB27-150 | 27 | 150 | 60 | 21 | M12 |
| BT50-FMB32-90 | 32 | 90 | 78 | 24 | M16 |
| BT50-FMB32-150 | 32 | 150 | 78 | 24 | M16 |
| BT50-FMB40-90 | 40 | 90 | 89 | 27 | M20 |

с.382



BT (MAS403)-MTA (Конус Морзе с "лапкой")

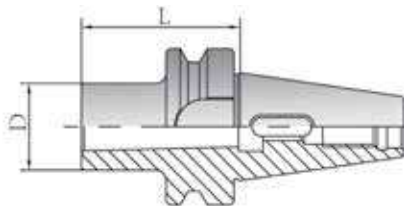

| Обозначение | Конус № | D | L |
|---------------|---------|----|-----|
| BT30-MTA1-45 | 1 | 25 | 45 |
| BT30-MTA2-60 | 2 | 32 | 60 |
| BT30-MTA3-80 | 3 | 40 | 80 |
| BT40-MTA1-45 | 1 | 25 | 45 |
| BT40-MTA2-50 | 2 | 32 | 50 |
| BT40-MTA2-120 | 2 | 32 | 120 |
| BT40-MTA3-70 | 3 | 40 | 70 |
| BT40-MTA3-135 | 3 | 40 | 135 |
| BT40-MTA4-95 | 4 | 48 | 95 |
| BT50-MTA1-45 | 1 | 25 | 45 |
| BT50-MTA2-60 | 2 | 32 | 60 |
| BT50-MTA3-65 | 3 | 40 | 65 |
| BT50-MTA3-150 | 3 | 40 | 150 |
| BT50-MTA4-95 | 4 | 48 | 95 |
| BT50-MTA5-105 | 5 | 63 | 105 |



BT (MAS403)-MTB (Конус Морзе с "натягом")

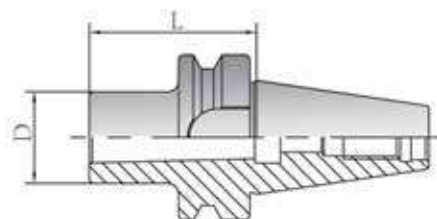

| Обозначение | Конус № | D | L |
|--------------|---------|----|----|
| BT30-MTB1-45 | 1 | 25 | 45 |
| BT30-MTB2-60 | 2 | 32 | 60 |
| BT40-MTB1-45 | 1 | 25 | 45 |
| BT40-MTB2-50 | 2 | 32 | 50 |
| BT40-MTB3-75 | 3 | 40 | 75 |
| BT40-MTB4-90 | 3 | 48 | 90 |
| BT40-MTB4-75 | 4 | 48 | 75 |
| BT40-MTB4-95 | 4 | 48 | 95 |
| BT50-MTB1-45 | 1 | 25 | 45 |
| BT50-MTB2-45 | 2 | 32 | 45 |
| BT50-MTB3-60 | 3 | 40 | 60 |
| BT50-MTB4-75 | 4 | 48 | 75 |



BT (MAS403)-SLA (Weldon)

BALANCED
G6.3
12 000 об/мин

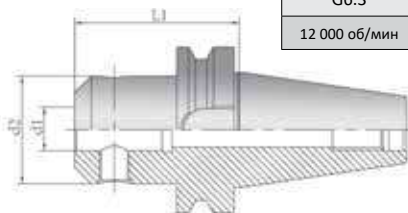

| Обозначение | d1 | d2 | L1 |
|----------------|----|----|-----|
| BT30-SLA10-60 | 10 | 35 | 60 |
| BT30-SLA12-60 | 12 | 42 | 60 |
| BT30-SLA16-75 | 16 | 48 | 75 |
| BT30-SLA20-75 | 20 | 52 | 75 |
| BT30-SLA25-90 | 25 | 65 | 90 |
| BT40-SLA06-50 | 6 | 25 | 50 |
| BT40-SLA06-100 | 6 | 25 | 100 |
| BT40-SLA08-50 | 8 | 28 | 50 |
| BT40-SLA08-100 | 8 | 28 | 100 |
| BT40-SLA10-63 | 10 | 35 | 63 |
| BT40-SLA10-100 | 10 | 35 | 100 |
| BT40-SLA12-63 | 12 | 42 | 63 |
| BT40-SLA12-100 | 12 | 42 | 100 |
| BT40-SLA16-63 | 16 | 48 | 63 |
| BT40-SLA16-100 | 16 | 48 | 100 |
| BT40-SLA20-63 | 20 | 52 | 63 |
| BT40-SLA20-100 | 20 | 52 | 100 |
| BT40-SLA25-100 | 25 | 65 | 100 |
| BT40-SLA32-100 | 32 | 72 | 100 |
| BT40-SLA40-120 | 40 | 90 | 120 |



BT (MAS403)-SLA (Weldon)

BALANCED
G6.3

12 000 об/мин

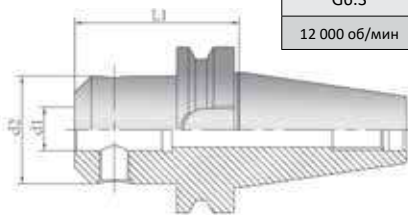

| Обозначение | d1 | d2 | L1 |
|----------------|----|----|-----|
| BT50-SLA16-100 | 16 | 48 | 100 |
| BT50-SLA20-100 | 20 | 52 | 100 |
| BT50-SLA25-100 | 25 | 65 | 100 |
| BT50-SLA25-150 | 25 | 65 | 150 |
| BT50-SLA32-105 | 32 | 72 | 105 |
| BT50-SLA32-150 | 32 | 72 | 150 |
| BT50-SLA40-115 | 40 | 90 | 115 |

с.382



BT (MAS403)-APU (Сверлильный патрон)

BALANCED
G6.3
12 000 об/мин

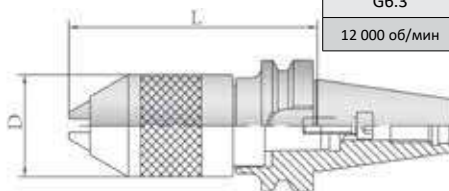

| Обозначение | Диапазон | D | L | |
|----------------|----------|------|------|-------|
| | | | Lmin | Lmax |
| BT30-APU08-80 | 1-8 | 36.3 | 75 | 82 |
| BT30-APU13-100 | 1-13 | 51.5 | 97 | 104.5 |
| BT40-APU08-85 | 1-8 | 36.3 | 79 | 86.5 |
| BT40-APU13-100 | 1-13 | 51.5 | 98 | 100 |
| BT40-APU16-105 | 3-16 | 58 | 116 | 102 |
| BT50-APU08-90 | 1-8 | 36.3 | 90 | 97.5 |
| BT50-APU13-100 | 1-13 | 51.5 | 79 | 104.5 |
| BT50-APU13-130 | 1-13 | 51.5 | 119 | 130 |
| BT50-APU16-130 | 3-16 | 58 | 116 | 130 |



BT (MAS403)-SC (Силовой патрон)

BALANCED
G6.3

12 000 об/мин

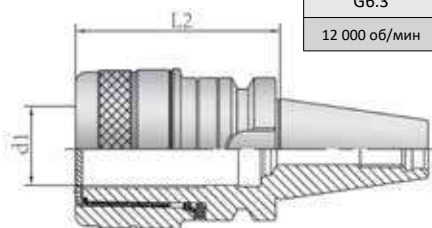

| Обозначение | d1 | L2 | Цанга |
|---------------|----|-----|-------|
| BT30-SC20-75 | 20 | 75 | SC20 |
| BT30-SC20-100 | 20 | 100 | SC20 |
| BT40-SC20-80 | 20 | 80 | SC20 |
| BT40-SC20-100 | 20 | 100 | SC20 |
| BT40-SC20-135 | 20 | 135 | SC20 |
| BT40-SC32-105 | 32 | 105 | SC32 |
| BT40-SC32-135 | 32 | 135 | SC32 |
| BT50-SC20-105 | 20 | 105 | SC20 |
| BT50-SC20-150 | 20 | 150 | SC20 |
| BT50-SC32-110 | 32 | 110 | SC32 |
| BT50-SC32-135 | 32 | 135 | SC32 |
| BT50-SC32-165 | 32 | 165 | SC32 |
| BT50-SC42-115 | 42 | 115 | SC42 |
| BT50-SC42-135 | 42 | 135 | SC42 |
| BT50-SC42-165 | 42 | 165 | SC42 |

с.382

с.388

с.393



SK (DIN 69871)-ER (Коническая цапга)

BALANCED
G6.3
12 000 об/мин

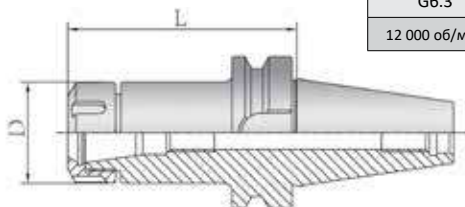

| Обозначение | D | L1 | Диапазон |
|---------------|----|-----|----------|
| SK30-ER16-70 | 28 | 70 | 0.5-10 |
| SK30-ER20-70 | 34 | 70 | 0.5-13 |
| SK30-ER20-100 | 34 | 100 | 0.5-13 |
| SK40-ER16-70 | 28 | 70 | 0.5-10 |
| SK40-ER16-100 | 28 | 100 | 0.5-10 |
| SK40-ER20-70 | 34 | 70 | 0.5-13 |
| SK40-ER20-100 | 34 | 100 | 0.5-13 |
| SK40-ER20-135 | 34 | 135 | 0.5-13 |
| SK40-ER25-70 | 42 | 70 | 0.5-16 |
| SK40-ER25-100 | 42 | 100 | 0.5-16 |
| SK40-ER25-150 | 42 | 150 | 0.5-16 |
| SK40-ER32-70 | 50 | 70 | 1-20 |
| SK40-ER32-100 | 50 | 100 | 1-20 |
| SK40-ER32-150 | 50 | 150 | 1-20 |
| SK40-ER40-80 | 63 | 80 | 2-26 |
| SK40-ER40-100 | 63 | 100 | 2-26 |
| SK40-ER40-135 | 63 | 135 | 2-26 |

с.384

с.385

с.392

с.391



SK (DIN 69871)-ER (Коническая цапга)

BALANCED
G6.3
12 000 об/мин

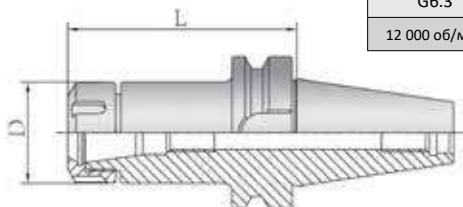

| Обозначение | D | L1 | Диапазон |
|---------------|----|-----|----------|
| SK50-ER16-100 | 28 | 70 | 0.5-10 |
| SK50-ER20-100 | 34 | 100 | 0.5-13 |
| SK50-ER25-70 | 50 | 70 | 0.5-16 |
| SK50-ER25-100 | 50 | 100 | 0.5-16 |
| SK50-ER25-150 | 50 | 150 | 0.5-16 |
| SK50-ER32-80 | 50 | 80 | 1-20 |
| SK50-ER32-120 | 50 | 120 | 1-20 |
| SK50-ER32-160 | 50 | 160 | 1-20 |
| SK50-ER32-200 | 50 | 200 | 1-20 |
| SK50-ER40-80 | 63 | 80 | 2-26 |
| SK50-ER40-120 | 63 | 120 | 2-26 |
| SK50-ER40-160 | 63 | 160 | 2-26 |
| SK40-ER40-200 | 63 | 160 | 2-26 |

с.384

с.385

с.392

с.391



SK (DIN 69871)-FMB (Торцевое крепление)

BALANCED
G6.3
12 000 об/мин

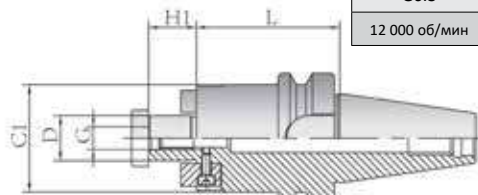

| Обозначение | D | L | C1 | H1 | G |
|----------------|----|-----|----|----|-----|
| SK30-FMB22-35 | 22 | 35 | 48 | 19 | M10 |
| SK30-FMB27-35 | 27 | 35 | 60 | 21 | M12 |
| SK40-FMB22-45 | 22 | 45 | 48 | 19 | M10 |
| SK40-FMB27-60 | 27 | 60 | 60 | 21 | M12 |
| SK40-FMB32-60 | 32 | 60 | 78 | 24 | M16 |
| SK40-FMB40-60 | 40 | 60 | 89 | 27 | M20 |
| SK50-FMB22-45 | 22 | 45 | 48 | 19 | M10 |
| SK50-FMB22-90 | 22 | 90 | 48 | 19 | M10 |
| SK50-FMB22-150 | 22 | 150 | 48 | 19 | M10 |
| SK50-FMB27-90 | 27 | 90 | 60 | 21 | M12 |
| SK50-FMB27-150 | 27 | 150 | 60 | 21 | M12 |
| SK50-FMB32-90 | 32 | 90 | 78 | 24 | M16 |
| SK50-FMB32-150 | 32 | 150 | 78 | 24 | M16 |
| SK50-FMB40-90 | 40 | 90 | 89 | 27 | M20 |

с.384



SK (DIN 69871)-MTA (Конус Морзе с "лапкой")

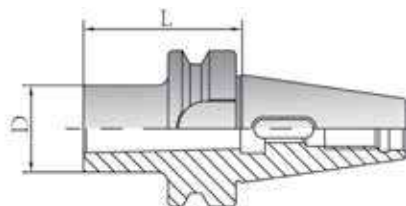

| Обозначение | Конус № | D | L |
|---------------|---------|----|-----|
| SK30-MTA1-50 | 1 | 25 | 50 |
| SK30-MTA2-50 | 2 | 32 | 50 |
| SK30-MTA3-80 | 3 | 40 | 80 |
| SK40-MTA1-50 | 1 | 25 | 50 |
| SK40-MTA2-50 | 2 | 32 | 50 |
| SK40-MTA3-70 | 3 | 40 | 70 |
| SK40-MTA4-95 | 4 | 48 | 95 |
| SK50-MTA1-45 | 1 | 25 | 45 |
| SK50-MTA2-60 | 2 | 32 | 60 |
| SK50-MTA3-65 | 3 | 40 | 65 |
| SK50-MTA4-95 | 4 | 48 | 95 |
| SK50-MTA5-105 | 5 | 70 | 105 |



SK (DIN 69871)-MTB (Конус Морзе с "натягом")

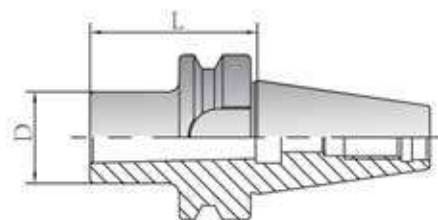

| Обозначение | Конус № | D | L |
|---------------|---------|----|-----|
| SK30-MTB1-50 | 1 | 25 | 50 |
| SK30-MTB2-60 | 2 | 32 | 60 |
| SK30-MTB3-75 | 3 | 40 | 75 |
| SK40-MTB1-50 | 1 | 25 | 50 |
| SK40-MTB2-50 | 2 | 32 | 50 |
| SK40-MTB3-70 | 3 | 48 | 70 |
| SK40-MTB4-95 | 4 | 48 | 95 |
| SK50-MTB1-45 | 1 | 25 | 45 |
| SK50-MTB2-60 | 2 | 32 | 60 |
| SK50-MTB3-65 | 3 | 40 | 65 |
| SK50-MTB4-95 | 4 | 48 | 95 |
| SK50-MTB5-105 | 5 | 63 | 105 |



SK (DIN 69871)-SLA (Weldon)

BALANCED
G6.3

12 000 об/мин

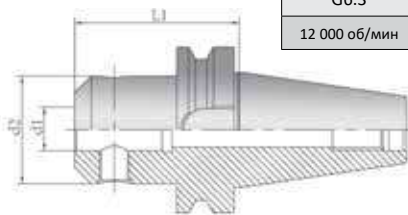

| Обозначение | d1 | d2 | L1 |
|----------------|----|----|-----|
| SK40-SLA06-50 | 6 | 25 | 50 |
| SK40-SLA06-100 | 6 | 25 | 100 |
| SK40-SLA08-50 | 8 | 28 | 50 |
| SK40-SLA08-100 | 8 | 28 | 100 |
| SK40-SLA10-63 | 10 | 35 | 63 |
| SK40-SLA10-100 | 10 | 35 | 100 |
| SK40-SLA12-63 | 12 | 42 | 63 |
| SK40-SLA12-100 | 12 | 42 | 100 |
| SK40-SLA16-63 | 16 | 48 | 63 |
| SK40-SLA16-100 | 16 | 48 | 100 |
| SK40-SLA20-63 | 20 | 52 | 63 |
| SK40-SLA20-100 | 20 | 52 | 100 |
| SK40-SLA25-100 | 25 | 65 | 100 |
| SK40-SLA32-100 | 32 | 72 | 100 |
| SK40-SLA40-120 | 40 | 90 | 120 |
| SK50-SLA16-100 | 16 | 48 | 100 |
| SK50-SLA20-100 | 20 | 52 | 100 |
| SK50-SLA25-100 | 25 | 65 | 100 |
| SK50-SLA25-150 | 25 | 65 | 150 |
| SK50-SLA32-105 | 32 | 72 | 105 |
| SK50-SLA32-150 | 32 | 72 | 150 |
| SK50-SLA40-115 | 40 | 90 | 115 |

с.384



SK (DIN 69871)-APU (Сверлильный патрон)

BALANCED
G6.3
12 000 об/мин

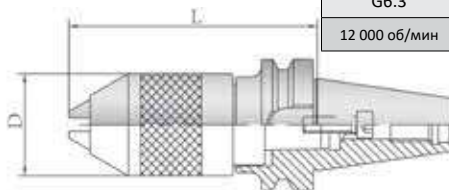

| Обозначение | Диапазон | D | L | |
|----------------|----------|------|------|-------|
| | | | Lmin | Lmax |
| SK30-APU80-80 | 1-8 | 36.3 | 75 | 82 |
| SK30-APU13-120 | 1-13 | 51.5 | 117 | 124.5 |
| SK40-APU08-75 | 1-8 | 36.3 | 74 | 81.5 |
| SK40-APU13-100 | 1-13 | 51.5 | 98 | 103 |
| SK40-APU16-125 | 3-16 | 58 | 120 | 127 |
| SK50-APU08-90 | 1-8 | 36.3 | 90 | 97.5 |
| SK50-APU08-75 | 1-8 | 51.5 | 74 | 81.5 |
| SK50-APU13-100 | 1-13 | 51.5 | 98 | 103 |
| SK50-APU16-105 | 3-16 | 58 | 100 | 111 |

с.384



SK (DIN 69871)-SC (Силовой патрон)

BALANCED
G6.3

12 000 об/мин

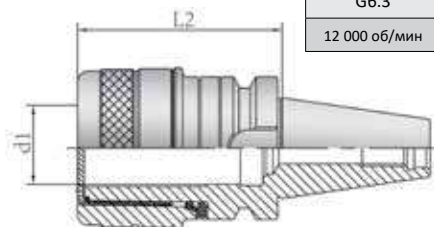

| Обозначение | d1 | L2 | Цанга |
|---------------|----|-----|-------|
| SK30-SC20-85 | 20 | 85 | SC20 |
| SK30-SC20-100 | 20 | 100 | SC20 |
| SK40-SC20-85 | 20 | 80 | SC20 |
| SK40-SC20-100 | 20 | 100 | SC20 |
| SK40-SC20-135 | 20 | 135 | SC20 |
| SK40-SC32-105 | 32 | 105 | SC32 |
| SK40-SC32-135 | 32 | 135 | SC32 |
| SK50-SC20-105 | 20 | 105 | SC20 |
| SK50-SC20-150 | 20 | 150 | SC20 |
| SK50-SC32-110 | 32 | 110 | SC32 |
| SK50-SC32-135 | 32 | 135 | SC32 |
| SK50-SC42-110 | 42 | 135 | SC42 |
| SK50-SC42-165 | 42 | 165 | SC42 |

с.384

с.388

с.393



HSK-ER (Коническая цапга)

BALANCED
G6.3

12 000 об/мин

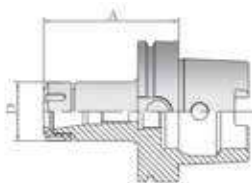

| Обозначение | D | A | Диапазон |
|-----------------|----|-----|----------|
| HSK50A-ER16-75 | 28 | 75 | 0.5-10 |
| HSK50A-ER20-75 | 34 | 75 | 0.5-13 |
| HSK50A-ER25-80 | 42 | 80 | 0.5-16 |
| HSK50A-ER32-100 | 50 | 100 | 1-20 |
| HSK63A-ER16-75 | 28 | 75 | 0.5-10 |
| HSK63A-ER16-100 | 28 | 100 | 0.5-10 |
| HSK63A-ER16-120 | 28 | 120 | 0.5-10 |
| HSK63A-ER20-80 | 34 | 80 | 0.5-13 |
| HSK63A-ER20-100 | 34 | 100 | 0.5-13 |
| HSK63A-ER20-120 | 34 | 120 | 0.5-13 |
| HSK63A-ER25-80 | 42 | 80 | 0.5-16 |
| HSK63A-ER25-100 | 42 | 100 | 0.5-16 |
| HSK63A-ER25-120 | 42 | 120 | 0.5-16 |
| HSK63A-ER32-100 | 50 | 100 | 1-20 |
| HSK63A-ER32-125 | 50 | 125 | 1-20 |
| HSK63A-ER40-100 | 63 | 100 | 2-26 |
| HSK63A-ER40-160 | 63 | 160 | 2-26 |

с.393

с.385

с.392

с.391



HSK-ER (Коническая цанга)

BALANCED
G6.3

12 000 об/мин

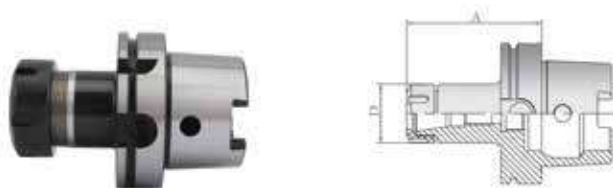

| Обозначение | D | A | Диапазон |
|------------------|----|-----|----------|
| HSK100A-ER16-100 | 28 | 100 | 0.5-10 |
| HSK100A-ER16-160 | 28 | 160 | 0.5-10 |
| HSK100A-ER20-100 | 34 | 100 | 0.5-13 |
| HSK100A-ER20-160 | 34 | 160 | 0.5-13 |
| HSK100A-ER25-100 | 42 | 100 | 0.5-16 |
| HSK100A-ER25-160 | 42 | 160 | 0.5-16 |
| HSK100A-ER32-100 | 50 | 100 | 1-20 |
| HSK100A-ER32-160 | 50 | 160 | 1-20 |
| HSK100A-ER40-100 | 63 | 100 | 2-26 |
| HSK100A-ER40-160 | 63 | 160 | 2-26 |

с.393

с.385

с.392

с.393

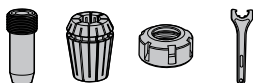

HSK-FMB (Торцевое крепление)

BALANCED
G6.3

12 000 об/мин

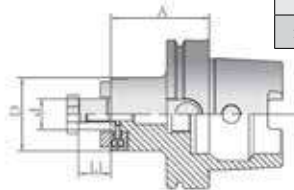

| Обозначение | d | A | L1 | D |
|------------------|----|-----|----|-----|
| HSK50A-FMB22-60 | 22 | 60 | 19 | 48 |
| HSK50A-FMB27-60 | 27 | 60 | 21 | 58 |
| HSK63A-FMB22-50 | 22 | 50 | 19 | 48 |
| HSK63A-FMB22-100 | 22 | 100 | 19 | 48 |
| HSK63A-FMB27-60 | 27 | 60 | 21 | 58 |
| HSK63A-FMB27-100 | 27 | 100 | 21 | 58 |
| HSK63A-FMB32-60 | 32 | 60 | 24 | 78 |
| HSK63A-FMB32-100 | 32 | 100 | 24 | 78 |
| HSK63A-FMB40-60 | 40 | 60 | 27 | 88 |
| HSK100A-FMB22-50 | 22 | 50 | 19 | 48 |
| HSK100A-FMB27-50 | 27 | 50 | 21 | 58 |
| HSK100A-FMB32-50 | 32 | 50 | 24 | 78 |
| HSK100A-FMB40-60 | 40 | 60 | 27 | 88 |
| HSK100A-FMB60-70 | 60 | 70 | 40 | 130 |



HSK-MTA (Конус Морзе с "лапкой")

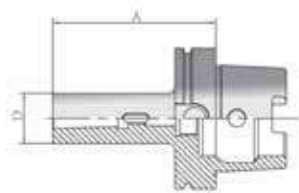

| Обозначение | Конус № | A | D |
|------------------|---------|-----|----|
| HSK50A-MTA1-100 | 1 | 100 | 25 |
| HSK50A-MTA2-120 | 2 | 120 | 32 |
| HSK50A-MTA3-140 | 3 | 140 | 40 |
| HSK63A-MTA1-100 | 1 | 100 | 25 |
| HSK63A-MTA2-120 | 2 | 120 | 32 |
| HSK63A-MTA3-140 | 3 | 140 | 40 |
| HSK63A-MTA4-160 | 4 | 160 | 48 |
| HSK100A-MTA1-110 | 1 | 110 | 25 |
| HSK100A-MTA2-120 | 2 | 120 | 32 |
| HSK100A-MTA3-150 | 3 | 150 | 40 |
| HSK100A-MTA4-170 | 4 | 170 | 48 |
| HSK100A-MTA5-200 | 5 | 200 | 63 |



HSK-MTB (Конус Морзе с "натягом")

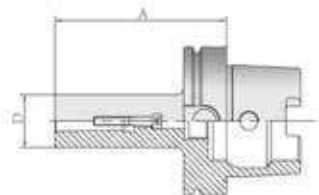

| Обозначение | Конус № | D | A |
|-----------------|---------|----|-----|
| HSK30A-MTB1-50 | 1 | 25 | 50 |
| HSK30A-MTB2-60 | 2 | 32 | 60 |
| HSK30A-MTB3-75 | 3 | 40 | 75 |
| HSK40A-MTB1-50 | 1 | 25 | 50 |
| HSK40A-MTB2-50 | 2 | 32 | 50 |
| HSK40A-MTB3-70 | 3 | 40 | 70 |
| HSK40A-MTB4-95 | 4 | 48 | 95 |
| HSK50A-MTB1-45 | 1 | 25 | 45 |
| HSK50A-MTB2-60 | 2 | 32 | 60 |
| HSK50A-MTB3-65 | 3 | 40 | 65 |
| HSK50A-MTB4-95 | 4 | 48 | 95 |
| HSK50A-MTB5-105 | 5 | 63 | 105 |



HSK-SLA (Weldon)

BALANCED
G6.3

12 000 об/мин

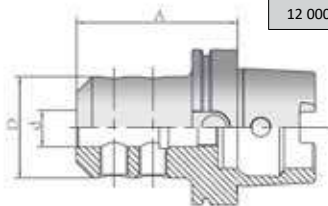

| Обозначение | d | A | D |
|-------------------|----|-----|----|
| HSK50A-SLA06-80 | 6 | 80 | 25 |
| HSK50A-SLA08-65 | 8 | 65 | 28 |
| HSK50A-SLA10-65 | 10 | 65 | 35 |
| HSK50A-SLA12-80 | 12 | 80 | 42 |
| HSK50A-SLA16-80 | 16 | 80 | 48 |
| HSK50A-SLA20-80 | 20 | 80 | 52 |
| HSK63A-SLA6-65 | 6 | 65 | 25 |
| HSK63A-SLA8-65 | 8 | 65 | 28 |
| HSK63A-SLA10-65 | 10 | 65 | 35 |
| HSK63A-SLA12-80 | 12 | 80 | 42 |
| HSK63A-SLA16-100 | 16 | 100 | 48 |
| HSK63A-SLA20-120 | 20 | 120 | 52 |
| HSK63A-SLA25-110 | 25 | 110 | 65 |
| HSK63A-SLA32-110 | 32 | 110 | 72 |
| HSK100A-SLA8-80 | 8 | 80 | 28 |
| HSK100A-SLA10-80 | 10 | 80 | 35 |
| HSK100A-SLA12-80 | 12 | 80 | 42 |
| HSK100A-SLA16-100 | 16 | 100 | 48 |
| HSK100A-SLA20-100 | 20 | 100 | 52 |
| HSK100A-SLA25-100 | 25 | 100 | 65 |
| HSK100A-SLA32-100 | 32 | 100 | 72 |

с.393



HSK-APU (Сверлильный патрон)

BALANCED
G6.3

12 000 об/мин



| Обозначение | Диапазон | D | L |
|-------------------|----------|----|-----|
| HSK50A-APU08-120 | 1-8 | 50 | 120 |
| HSK63A-APU13-150 | 1-13 | 50 | 150 |
| HSK63A-APU16-155 | 3-16 | 57 | 155 |
| HSK100A-APU13-155 | 1-13 | 50 | 155 |
| HSK100A-SPU16-160 | 3-16 | 57 | 160 |



HSK-SC (Силовой патрон)

BALANCED
G6.3

12 000 об/мин

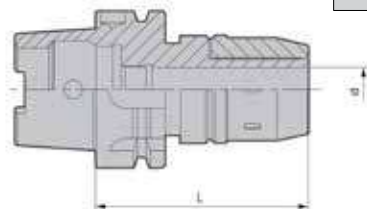

| Обозначение | d | L | Цанга |
|------------------|----|-----|-------|
| HSK50A-SC16-80 | 16 | 80 | SC16 |
| HSK63A-SC16-80 | 16 | 80 | SC16 |
| HSK63A-SC16-100 | 16 | 100 | SC16 |
| HSK63A-SC20-110 | 20 | 110 | SC20 |
| HSK100A-SC16-115 | 16 | 115 | SC16 |
| HSK100A-SC20-115 | 20 | 115 | SC20 |

с.393

с.388

с.393



Переходник конус Морзе - цапга коническая ER

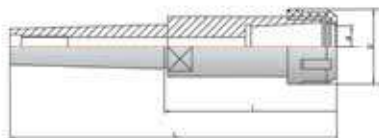

| Обозначение | L | l | D | Md |
|-------------|-----|----|----|-----|
| MTB1-ER11 | 85 | 30 | 19 | M6 |
| MTB2-ER11 | 96 | 30 | 19 | M10 |
| MTB3-ER11 | 119 | 30 | 19 | M12 |
| MTB1-ER16 | 95 | 40 | 28 | M6 |
| MTB2-ER16 | 106 | 40 | 28 | M10 |
| MTB3-ER16 | 129 | 40 | 28 | M12 |
| MTB1-ER20 | 95 | 40 | 35 | M6 |
| MTB2-ER20 | 106 | 40 | 35 | M10 |
| MTB3-ER20 | 126 | 40 | 35 | M12 |
| MTB1-ER25 | 95 | 37 | 42 | M6 |
| MTB2-ER25 | 103 | 37 | 42 | M10 |
| MTB3-ER25 | 123 | 37 | 42 | M12 |
| MTB4-ER25 | 145 | 37 | 42 | M16 |
| MTB2-ER32 | 116 | 50 | 50 | M10 |
| MTB3-ER32 | 136 | 50 | 50 | M12 |
| MTB4-ER32 | 163 | 50 | 50 | M16 |
| MTB3-ER40 | 152 | 66 | 63 | M12 |
| MTB4-ER40 | 174 | 66 | 63 | M16 |

Удлинитель под цангу коническую ER

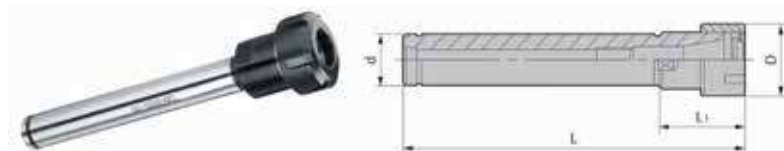

| Обозначение | D | d | L1 | L |
|--------------|----|----|----|-----|
| C16-ER16-100 | 28 | 16 | 36 | 136 |
| C16-ER16-150 | 28 | 16 | 30 | 180 |
| C20-ER16-100 | 34 | 16 | 36 | 136 |
| C20-ER16-150 | 28 | 20 | 30 | 180 |
| C20-ER20-100 | 34 | 20 | 36 | 136 |
| C20-ER20-150 | 34 | 20 | 36 | 186 |
| C20-ER25-100 | 42 | 20 | 46 | 146 |
| C20-ER25-150 | 42 | 20 | 46 | 196 |
| C25-ER16-100 | 28 | 25 | 30 | 130 |
| C25-ER16-150 | 28 | 25 | 30 | 180 |
| C25-ER20-100 | 34 | 25 | 36 | 136 |
| C25-ER20-150 | 34 | 25 | 36 | 186 |
| C25-ER25-100 | 42 | 25 | 46 | 146 |
| C25-ER25-150 | 42 | 25 | 46 | 196 |
| C32-ER25-100 | 42 | 32 | 46 | 146 |
| C32-ER25-150 | 42 | 32 | 46 | 196 |

Удлинитель под цангу коническую ER



| Обозначение | D | d | L1 | L |
|---------------|----|----|------|-------|
| C12-ER11M-100 | 16 | 12 | 17 | 130,5 |
| C16-ER11M-100 | 16 | 16 | 18,5 | 128,5 |
| C16-ER16M-100 | 23 | 16 | 18,5 | 158,5 |
| C20-ER16M-100 | 23 | 20 | 25 | 125 |
| C20-ER20M-100 | 28 | 20 | 40 | 140 |

Штрель (натяжной винт) для ВТ

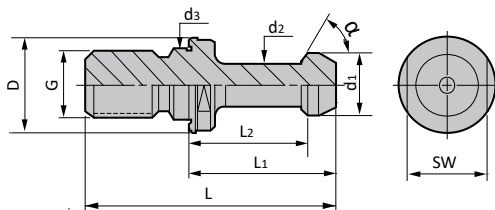

| Наименование | D | d1 | d2 | d3 | L1 | L2 | L | α | G |
|--------------|------|----|----|------|----|----|----|----------|-----|
| PSBT3030 | 16,5 | 11 | 7 | 12,5 | 23 | 18 | 43 | 30° | M12 |
| PSBT3045 | | | | | | | | 45° | |
| PSBT3060 | | | | | | | | 60° | |
| PSBT3090 | | | | | | | | 90° | |
| PSBT4030 | 23 | 15 | 10 | 17 | 35 | 28 | 60 | 30° | M16 |
| PSBT4045 | | | | | | | | 45° | |
| PSBT4060 | | | | | | | | 60° | |
| PSBT4090 | | | | | | | | 90° | |
| PSBT5030 | 38 | 23 | 17 | 25 | 45 | 35 | 85 | 30° | M24 |
| PSBT5045 | | | | | | | | 45° | |
| PSBT5060 | | | | | | | | 60° | |
| PSBT5090 | | | | | | | | 90° | |

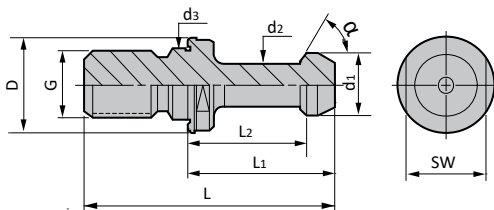
Штрель (натяжной винт) с отв. для СОЖ для ВТ

| Наименование | D | d1 | d2 | d3 | L1 | L2 | L | α | G |
|--------------|------|----|----|------|----|----|----|----------|-----|
| PSBT3030C | 16,5 | 11 | 7 | 12,5 | 23 | 18 | 43 | 30° | M12 |
| PSBT3045C | | | | | | | | 45° | |
| PSBT3060C | | | | | | | | 60° | |
| PSBT3090C | | | | | | | | 90° | |
| PSBT4030C | 23 | 15 | 10 | 17 | 35 | 28 | 60 | 30° | M16 |
| PSBT4045C | | | | | | | | 45° | |
| PSBT4060C | | | | | | | | 60° | |
| PSBT4090C | | | | | | | | 90° | |
| PSBT5030C | 38 | 23 | 17 | 25 | 45 | 35 | 85 | 30° | M24 |
| PSBT5045C | | | | | | | | 45° | |
| PSBT5060C | | | | | | | | 60° | |
| PSBT5090C | | | | | | | | 90° | |

Штрель (натяжной винт) для SK

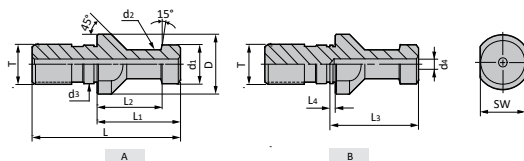

| Наименование | Исполнение | D | d1 | d2 | d3 | d4 | L1 | L2 | L3 | L4 | L | T |
|--------------|------------|----|----|----|----|------|----|----|----|-----|----|-----|
| PSSK30A | A | 17 | 13 | 9 | 13 | - | 24 | 19 | 24 | - | 44 | M12 |
| PSSK40A | A | 23 | 19 | 14 | 17 | 7 | 26 | 20 | 26 | 3.0 | 54 | M16 |
| PSSK50A | A | 36 | 28 | 21 | 25 | 11.5 | 34 | 25 | 34 | 4.5 | 74 | M24 |
| PSSK30B | B | 17 | 13 | 9 | 13 | - | 24 | 19 | 24 | - | 44 | M12 |
| PSSK40B | B | 23 | 19 | 14 | 17 | 7 | 26 | 20 | 26 | 3.0 | 54 | M16 |
| PSSK50B | B | 36 | 28 | 21 | 25 | 11.5 | 34 | 25 | 34 | 4.5 | 74 | M24 |

Цанга коническая - ER (стандартные)

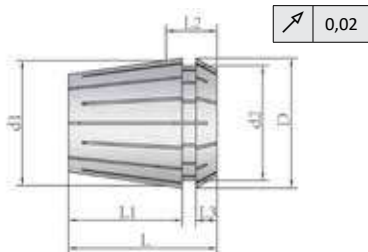

| ER11 | | ER16 | | ER20 | | ER25 | | ER32 | | ER40 | |
|-------------|----------|-------------|----------|-------------|-----------|-------------|-----------|-------------|-----------|-------------|-----------|
| Обозначение | Диапазон | Обозначение | Диапазон | Обозначение | Диапазон | Обозначение | Диапазон | Обозначение | Диапазон | Обозначение | Диапазон |
| CER11010 | 1.0-0.5 | CER16010 | 1.0-0.5 | CER20010 | 1.0-0.5 | CER25010 | 1.0-0.5 | CER32010 | 1.0-0.5 | CER40030 | 3.0-2.0 |
| CER11015 | 1.5-1.0 | CER16020 | 2.0-1.0 | CER20020 | 2.0-1.0 | CER25020 | 2.0-1.0 | CER32020 | 2.0-1.0 | CER40040 | 4.0-3.0 |
| CER11020 | 2.0-1.5 | CER16030 | 3.0-2.0 | CER20030 | 3.0-2.0 | CER25030 | 3.0-2.0 | CER32030 | 3.0-2.0 | CER40050 | 5.0-4.0 |
| CER11025 | 2.5-2.0 | CER16040 | 4.0-3.0 | CER20040 | 4.0-3.0 | CER25040 | 4.0-3.0 | CER32040 | 4.0-3.0 | CER40060 | 6.0-5.0 |
| CER11030 | 3.0-2.5 | CER16050 | 5.0-4.0 | CER20050 | 5.0-4.0 | CER25050 | 5.0-4.0 | CER32050 | 5.0-4.0 | CER40070 | 7.0-6.0 |
| CER11035 | 3.5-3.0 | CER16060 | 6.0-5.0 | CER20060 | 6.0-5.0 | CER25060 | 6.0-5.0 | CER32060 | 6.0-5.0 | CER40080 | 8.0-7.0 |
| CER11040 | 4.0-3.5 | CER16070 | 7.0-6.0 | CER20070 | 7.0-6.0 | CER25070 | 7.0-6.0 | CER32070 | 7.0-6.0 | CER40090 | 9.0-8.0 |
| CER11045 | 4.5-4.0 | CER16080 | 8.0-7.0 | CER20080 | 8.0-7.0 | CER25080 | 8.0-7.0 | CER32080 | 8.0-7.0 | CER40100 | 10.0-9.0 |
| CER11050 | 5.0-4.5 | CER16090 | 9.0-8.0 | CER20090 | 9.0-8.0 | CER25090 | 9.0-8.0 | CER32090 | 9.0-8.0 | CER40110 | 11.0-10.0 |
| CER11055 | 5.5-5.0 | CER16100 | 10.0-9.0 | CER20100 | 10.0-9.0 | CER25100 | 10.0-9.0 | CER32100 | 10.0-9.0 | CER40120 | 12.0-11.0 |
| CER11060 | 6.0-5.5 | | | CER20110 | 11.0-10.0 | CER25110 | 11.0-10.0 | CER32110 | 11.0-10.0 | CER40130 | 13.0-12.0 |
| CER11065 | 6.5-6.0 | | | CER20120 | 12.0-11.0 | CER25120 | 12.0-11.0 | CER32120 | 12.0-11.0 | CER40140 | 14.0-13.0 |
| CER11070 | 7.0-6.5 | | | CER20130 | 13.0-12.0 | CER25130 | 13.0-12.0 | CER32130 | 13.0-12.0 | CER40150 | 15.0-14.0 |
| | | | | | | CER25140 | 14.0-13.0 | CER32140 | 14.0-13.0 | CER40160 | 16.0-15.0 |
| | | | | | | CER25150 | 15.0-14.0 | CER32150 | 15.0-14.0 | CER40170 | 17.0-16.0 |
| | | | | | | CER25160 | 16.0-15.0 | CER32160 | 16.0-15.0 | CER40180 | 18.0-17.0 |
| | | | | | | | | CER32170 | 17.0-16.0 | CER40190 | 19.0-18.0 |
| | | | | | | | | CER32180 | 18.0-17.0 | CER40200 | 20.0-19.0 |
| | | | | | | | | CER32190 | 19.0-18.0 | CER40210 | 21.0-20.0 |
| | | | | | | | | CER32200 | 20.0-19.0 | CER40220 | 22.0-21.0 |
| | | | | | | | | | | CER40230 | 23.0-22.0 |
| | | | | | | | | | | CER40240 | 24.0-23.0 |
| | | | | | | | | | | CER40250 | 25.0-24.0 |
| | | | | | | | | | | CER40260 | 26.0-25.0 |

Цанга коническая - ER (точные)

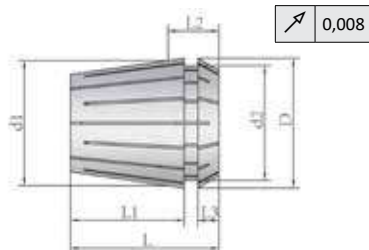

| ER11 | | ER16 | | ER20 | | ER25 | | ER32 | | ER40 | |
|-------------|---------|-------------|---------|-------------|---------|-------------|---------|-------------|---------|-------------|---------|
| Обозначение | Диаметр | Обозначение | Диаметр | Обозначение | Диаметр | Обозначение | Диаметр | Обозначение | Диаметр | Обозначение | Диаметр |
| CER11010AA | 1.0 | CER16010AA | 1.0 | CER20010AA | 1.0 | CER25010AA | 1.0 | CER32010AA | 1.0 | CER40030AA | 3.0 |
| CER11020AA | 2.0 | CER16020AA | 2.0 | CER20020AA | 2.0 | CER25020AA | 2.0 | CER32020AA | 2.0 | CER40040AA | 4.0 |
| CER11030AA | 3.0 | CER16030AA | 3.0 | CER20030AA | 3.0 | CER25030AA | 3.0 | CER32030AA | 3.0 | CER40050AA | 5.0 |
| CER11040AA | 4.0 | CER16040AA | 4.0 | CER20040AA | 4.0 | CER25040AA | 4.0 | CER32040AA | 4.0 | CER40060AA | 6.0 |
| CER11050AA | 5.0 | CER16050AA | 5.0 | CER20050AA | 5.0 | CER25050AA | 5.0 | CER32050AA | 5.0 | CER40070AA | 7.0 |
| CER11060AA | 6.0 | CER16060AA | 6.0 | CER20060AA | 6.0 | CER25060AA | 6.0 | CER32060AA | 6.0 | CER40080AA | 8.0 |
| CER11070AA | 7.0 | CER16070AA | 7.0 | CER20070AA | 7.0 | CER25070AA | 7.0 | CER32070AA | 7.0 | CER40090AA | 9.0 |
| | | CER16080AA | 8.0 | CER20080AA | 8.0 | CER25080AA | 8.0 | CER32080AA | 8.0 | CER40100AA | 10.0 |
| | | CER16090AA | 9.0 | CER20090AA | 9.0 | CER25090AA | 9.0 | CER32090AA | 9.0 | CER40110AA | 11.0 |
| | | CER16100AA | 10.0 | CER20100AA | 10.0 | CER25100AA | 10.0 | CER32100AA | 10.0 | CER40120AA | 12.0 |
| | | | | CER20110AA | 11.0 | CER25110AA | 11.0 | CER32110AA | 11.0 | CER40130AA | 13.0 |
| | | | | CER20120AA | 12.0 | CER25120AA | 12.0 | CER32120AA | 12.0 | CER40140AA | 14.0 |
| | | | | CER20130AA | 13.0 | CER25130AA | 13.0 | CER32130AA | 13.0 | CER40150AA | 15.0 |
| | | | | | | CER25140AA | 14.0 | CER32140AA | 14.0 | CER40160AA | 16.0 |
| | | | | | | CER25150AA | 15.0 | CER32150AA | 15.0 | CER40170AA | 17.0 |
| | | | | | | CER25160AA | 16.0 | CER32160AA | 16.0 | CER40180AA | 18.0 |
| | | | | | | | | CER32170AA | 17.0 | CER40190AA | 19.0 |
| | | | | | | | | CER32180AA | 18.0 | CER40200AA | 20.0 |
| | | | | | | | | CER32190AA | 19.0 | CER40210AA | 21.0 |
| | | | | | | | | CER32200AA | 20.0 | CER40220AA | 22.0 |
| | | | | | | | | | | CER40230AA | 23.0 |
| | | | | | | | | | | CER40240AA | 24.0 |
| | | | | | | | | | | CER40250AA | 25.0 |
| | | | | | | | | | | CER40260AA | 26.0 |

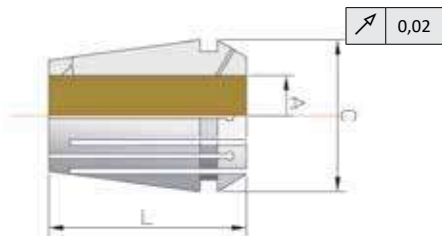
Цанга коническая - ER (герметичная)

| ER16 | | ER20 | | ER25 | | ER32 | | ER40 | |
|-------------|----------|-------------|-----------|-------------|-----------|-------------|-----------|-------------|-----------|
| Обозначение | Диапазон | Обозначение | Диапазон | Обозначение | Диапазон | Обозначение | Диапазон | Обозначение | Диапазон |
| ERS16030 | 3.0-2.0 | ERS20030 | 3.0-2.0 | ERS25030 | 3.0-2.0 | ERS32030 | 3.0-2.0 | ERS40030 | 3.0-2.0 |
| ERS16040 | 4.0-3.0 | ERS20040 | 4.0-3.0 | ERS25040 | 4.0-3.0 | ERS32040 | 4.0-3.0 | ERS40040 | 4.0-3.0 |
| ERS16050 | 5.0-4.0 | ERS20050 | 5.0-4.0 | ERS25050 | 5.0-4.0 | ERS32050 | 5.0-4.0 | ERS40050 | 5.0-4.0 |
| ERS16060 | 6.0-5.0 | ERS20060 | 6.0-5.0 | ERS25060 | 6.0-5.0 | ERS32060 | 6.0-5.0 | ERS40060 | 6.0-5.0 |
| ERS16070 | 7.0-6.0 | ERS20070 | 7.0-6.0 | ERS25070 | 7.0-6.0 | ERS32070 | 7.0-6.0 | ERS40070 | 7.0-6.0 |
| ERS16080 | 8.0-7.0 | ERS20080 | 8.0-7.0 | ERS25080 | 8.0-7.0 | ERS32080 | 8.0-7.0 | ERS40080 | 8.0-7.0 |
| ERS16090 | 9.0-8.0 | ERS20090 | 9.0-8.0 | ERS25090 | 9.0-8.0 | ERS32090 | 9.0-8.0 | ERS40090 | 9.0-8.0 |
| ERS16100 | 10.0-9.0 | ERS20100 | 10.0-9.0 | ERS25100 | 10.0-9.0 | ERS32100 | 10.0-9.0 | ERS40100 | 10.0-9.0 |
| | | ERS20110 | 11.0-10.0 | ERS25110 | 11.0-10.0 | ERS32110 | 11.0-10.0 | ERS40110 | 11.0-10.0 |
| | | ERS20120 | 12.0-11.0 | ERS25120 | 12.0-11.0 | ERS32120 | 12.0-11.0 | ERS40120 | 12.0-11.0 |
| | | ERS20130 | 13.0-12.0 | ERS25130 | 13.0-12.0 | ERS32130 | 13.0-12.0 | ERS40130 | 13.0-12.0 |
| | | | | ERS25140 | 14.0-13.0 | ERS32140 | 14.0-13.0 | ERS40140 | 14.0-13.0 |
| | | | | ERS25150 | 15.0-14.0 | ERS32150 | 15.0-14.0 | ERS40150 | 15.0-14.0 |
| | | | | ERS25160 | 16.0-15.0 | ERS32160 | 16.0-15.0 | ERS40160 | 16.0-15.0 |
| | | | | | | ERS32170 | 17.0-16.0 | ERS40170 | 17.0-16.0 |
| | | | | | | ERS32180 | 18.0-17.0 | ERS40180 | 18.0-17.0 |
| | | | | | | ERS32190 | 19.0-18.0 | ERS40190 | 19.0-18.0 |
| | | | | | | ERS32200 | 20.0-19.0 | ERS40200 | 20.0-19.0 |
| | | | | | | | | ERS40210 | 21.0-20.0 |
| | | | | | | | | ERS40220 | 22.0-21.0 |
| | | | | | | | | ERS40230 | 23.0-22.0 |
| | | | | | | | | ERS40240 | 24.0-23.0 |
| | | | | | | | | ERS40250 | 25.0-24.0 |
| | | | | | | | | ERS40260 | 26.0-25.0 |

Цанга цилиндрическая- SC



| SC16 | | SC20 | | SC25 | | SC32 | | SC40 | |
|-------------|----------|-------------|----------|-------------|----------|-------------|----------|-------------|----------|
| Обозначение | Диапазон | Обозначение | Диапазон | Обозначение | Диапазон | Обозначение | Диапазон | Обозначение | Диапазон |
| CSC16030 | 3.0 | CSC20030 | 3.0 | CSC25030 | 3.0 | CSC32030 | 3.0 | CSC42030 | 3.0 |
| CSC16040 | 4.0 | CSC20040 | 4.0 | CSC25040 | 4.0 | CSC32040 | 4.0 | CSC42040 | 4.0 |
| CSC16050 | 5.0 | CSC20050 | 5.0 | CSC25050 | 5.0 | CSC32050 | 5.0 | CSC42050 | 5.0 |
| CSC16060 | 6.0 | CSC20060 | 6.0 | CSC25060 | 6.0 | CSC32060 | 6.0 | CSC42060 | 6.0 |
| CSC16080 | 8.0 | CSC20080 | 8.0 | CSC25080 | 8.0 | CSC32080 | 8.0 | CSC42080 | 8.0 |
| CSC16100 | 10.0 | CSC20100 | 10.0 | CSC25100 | 10.0 | CSC32100 | 10.0 | CSC42100 | 10.0 |
| CSC16120 | 12.0 | CSC20120 | 12.0 | CSC25120 | 12.0 | CSC32120 | 12.0 | CSC42120 | 12.0 |
| | | CSC20140 | 14.0 | CSC25140 | 14.0 | CSC32140 | 14.0 | CSC42140 | 14.0 |
| | | CSC20160 | 16.0 | CSC25160 | 16.0 | CSC32160 | 16.0 | CSC42160 | 16.0 |
| | | | | CSC25180 | 18.0 | CSC32180 | 18.0 | CSC42180 | 18.0 |
| | | | | CSC25200 | 20.0 | CSC32200 | 20.0 | CSC42200 | 20.0 |
| | | | | | | CSC32250 | 25.0 | CSC42250 | 25.0 |
| | | | | | | | | CSC42280 | 28.0 |
| | | | | | | | | CSC42300 | 30.0 |
| | | | | | | | | CSC42320 | 32.0 |

Наборы цанг конических (ER)
 0,02



| Наименование | ER | Количество | Перечень диаметров |
|--------------|------|------------|---|
| SETER11-9 | ER11 | 9 | 3; 3,5; 4; 4,5; 5; 5,5; 6; 6,5; 7 |
| SETER16-8 | ER16 | 8 | 3; 4; 5; 6; 7; 8; 9; 10 |
| SETER20-11 | ER20 | 11 | 3; 4; 5; 6; 7; 8; 9; 10; 11; 12; 13 |
| SETER25-14 | ER25 | 14 | 3; 4; 5; 6; 7; 8; 9; 10; 11; 12; 13; 14; 15; 16 |
| SETER32-18 | ER32 | 18 | 3; 4; 5; 6; 7; 8; 9; 10; 11; 12; 13; 14; 15; 16; 17; 18; 19; 20 |
| SETER40-15 | ER40 | 15 | 4; 5; 6; 7; 8; 10; 12; 14; 15; 16; 18; 20; 22; 24; 26 |
| SETER40-18 | | 18 | 4; 5; 6; 7; 8; 9; 10; 11; 12; 13; 14; 15; 16; 17; 18; 19; 20; 25 |
| SETER40-23 | | 23 | 4; 5; 6; 7; 8; 9; 10; 11; 12; 13; 14; 15; 16; 17; 18; 19; 20; 21; 22; 23; 24; 25; 26 |
| SETER40-24 | | 24 | 3; 4; 5; 6; 7; 8; 9; 10; 11; 12; 13; 14; 15; 16; 17; 18; 19; 20; 21; 22; 23; 24; 25; 26 |

Наборы цанг конических (ER-AA) точных

 0,008

| Наименование | ER | Количество | Перечень диаметров |
|--------------|------|------------|---|
| SETERAA11-7 | ER11 | 7 | 1; 2; 3; 4; 5; 6; 7 |
| SETERAA11-9 | | 9 | 3; 3,5; 4; 4,5; 5; 5,5; 6; 6,5; 7 |
| SETERAA11-13 | | 13 | 1; 1,5; 2; 2,5; 3; 3,5; 4; 4,5; 5; 5,5; 6; 6,5; 7 |
| SETERAA16-8 | ER16 | 8 | 3; 4; 5; 6; 7; 8; 9; 10 |
| SETERAA16-10 | | 10 | 1; 2; 3; 4; 5; 6; 7; 8; 9; 10 |
| SETERAA20-11 | ER20 | 11 | 3; 4; 5; 6; 7; 8; 9; 10; 11; 12; 13 |
| SETERAA20-13 | | 13 | 1; 2; 3; 4; 5; 6; 7; 8; 9; 10; 11; 12; 13 |
| SETERAA25-14 | ER25 | 14 | 3; 4; 5; 6; 7; 8; 9; 10; 11; 12; 13; 14; 15; 16 |
| SETERAA25-15 | | 15 | 2; 3; 4; 5; 6; 7; 8; 9; 10; 11; 12; 13; 14; 15; 16 |
| SETERAA32-18 | ER32 | 18 | 3; 4; 5; 6; 7; 8; 9; 10; 11; 12; 13; 14; 15; 16; 17; 18; 19; 20 |
| SETERAA32-19 | | 19 | 2; 3; 4; 5; 6; 7; 8; 9; 10; 11; 12; 13; 14; 15; 16; 17; 18; 19; 20 |
| SETERAA40-15 | ER40 | 15 | 4; 5; 6; 7; 8; 10; 12; 14; 15; 16; 18; 20; 22; 24; 26 |
| SETERAA40-18 | | 18 | 4; 5; 6; 7; 8; 9; 10; 11; 12; 13; 14; 15; 16; 17; 18; 19; 20; 25 |
| SETERAA40-23 | | 23 | 4; 5; 6; 7; 8; 9; 10; 11; 12; 13; 14; 15; 16; 17; 18; 19; 20; 21; 22; 23; 24; 25; 26 |
| SETERAA40-24 | | 24 | 3; 4; 5; 6; 7; 8; 9; 10; 11; 12; 13; 14; 15; 16; 17; 18; 19; 20; 21; 22; 23; 24; 25; 26 |

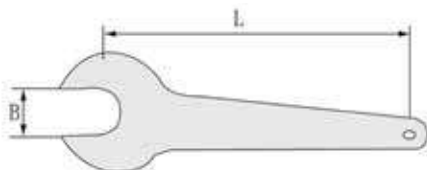
Ключи для базовых держателей под цанги (ER)



| Наименование | Тип гайки |
|--------------|-----------|
| WER16-A | A |
| WER20-A | A |



| Наименование | Тип гайки |
|--------------|-----------|
| WER11-M | M |
| WER16-M | M |
| WER20-M | M |
| WER25-M | M |



| Наименование | Тип гайки |
|----------------|-----------|
| WER25-UM.KM/RD | UM |
| WER32-UM.KM/RD | UM |
| WER40-UM.KM/RD | UM |

Гайки для базовых держателей под цанги (ER)

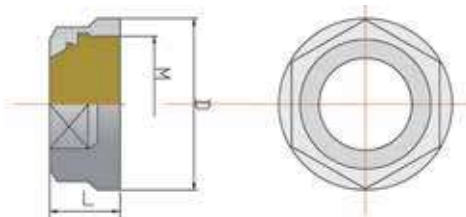

| Наименование | Тип гайки | M | D, мм | L, мм |
|--------------|-----------|----------|-------|-------|
| NER11-A | A | M14X0.75 | 19 | 11.3 |
| NER16-A | A | M22X1.5 | 28 | 17.5 |
| NER20-A | A | M25X1.5 | 34 | 19 |

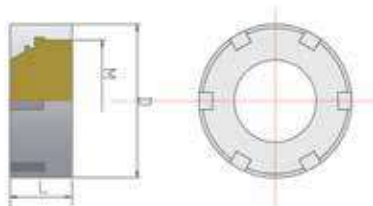

| Наименование | Тип гайки | M | D, мм | L, мм |
|--------------|-----------|----------|-------|-------|
| NER11-M | M | M13X0.75 | 16 | 12 |
| NER16-M | M | M19X1 | 22 | 18 |
| NER20-M | M | M24X1 | 28 | 19 |
| NER25-M | M | M30X1 | 35 | 20 |

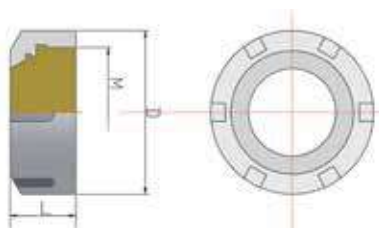

| Наименование | Тип гайки | M | D, мм | L, мм |
|----------------|-----------|---------|-------|-------|
| NER16-UM.KM/RD | UM | M22X1.5 | 32 | 17 |
| NER20-UM.KM/RD | UM | M25X1.5 | 35 | 19 |
| NER25-UM.KM/RD | UM | M32X1.5 | 42 | 20 |
| NER32-UM.KM/RD | UM | M40X1.5 | 50 | 22.5 |
| NER40-UM.KM/RD | UM | M50X1.5 | 63 | 25.5 |

Ключи для силовых базовых держателей (SC)



| Наименование | Типоразмер |
|--------------|------------|
| WSC16 | 16 |
| WSC20 | 20 |
| WSC32 | 32 |
| WSC42 | 42 |

Трубка для подвода СОЖ для держателей HSK



| Наименование | Типоразмер |
|--------------|------------|
| СТНСК40А | НСК40 |
| СТНСК50А | НСК50 |
| СТНСК63А | НСК63 |
| СТНСК100А | НСК100 |

Втулка переходная

Исполнение
А



Исполнение
В

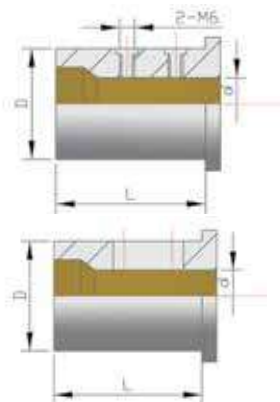

| Наименование | Исполнение | d | D | L |
|--------------|------------|----|----|----|
| SL2506 | A | 6 | 25 | 46 |
| SL2508 | A | 8 | | |
| SL2510 | A | 10 | | |
| SL2512 | A | 12 | | |
| SL2516 | B | 16 | | |
| SL2520 | B | 20 | | |
| SL3206 | A | 6 | 32 | 56 |
| SL3208 | A | 8 | | |
| SL3210 | A | 10 | | |
| SL3212 | A | 12 | | |
| SL3216 | B | 16 | | |
| SL3220 | B | 20 | | |
| SL3225 | B | 25 | | |
| SL4006 | A | 6 | 40 | 71 |
| SL4008 | A | 8 | | |
| SL4010 | A | 10 | | |
| SL4012 | A | 12 | | |
| SL4016 | B | 16 | | |
| SL4020 | B | 20 | | |
| SL4025 | B | 25 | | |
| SL4032 | B | 32 | | |

Приспособление для установки базовых держателей



| Наименование | Базовый держатель | Наименование | Базовый держатель |
|--------------|-------------------|--------------|-------------------|
| TL-BT30 | BT-30 | TL-SK50 | SK-50 |
| TL-BT40 | BT-40 | TL-HSK50 | HSK-50 |
| TL-BT50 | BT-50 | TL-HSK63 | HSK-63 |
| TL-SK30 | SK-30 | TL-HSK100 | HSK-100 |
| TL-SK40 | SK-40 | | |

